

HOW TO MAKE AN ORIGAMI SWAN

BY FAYE PHILLIPS

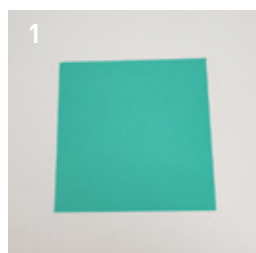

1 START WITH A SQUARE

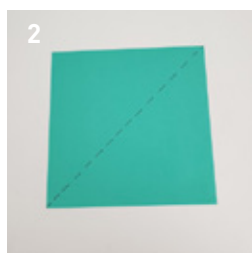

2 FOLD IN HALF

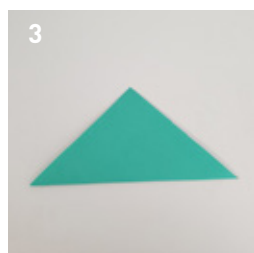

3 FOLD THIS TRIANGLE IN HALF

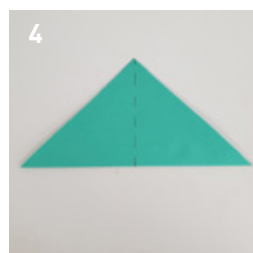

4 FOLD THE TOP POINT DOWN

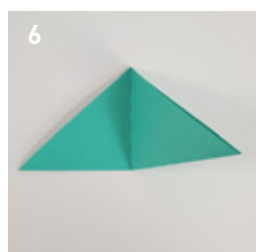

6 UNFOLD LAST TRIANGLE

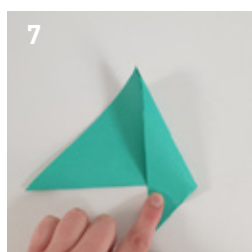

7 FOLD SIDES TO CENTRE

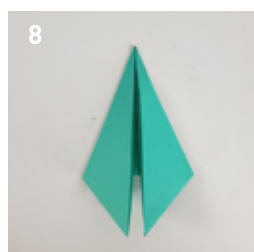

8 BOTH SIDES FOLDED IN

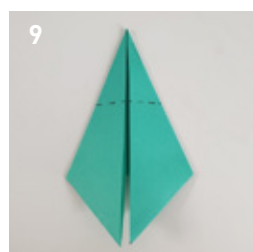

9 FOLD THE TOP POINT DOWN



11 FOLD THIS IN HALF



12 PULL TRIANGLE OUT



13 PULL TRIANGLE OUT



14 FOLD TOP DOWN

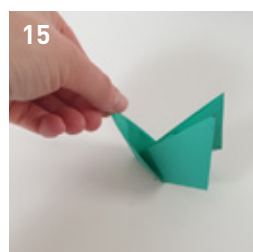

16 SQUEEZE TOGETHER TO MAKE FACE

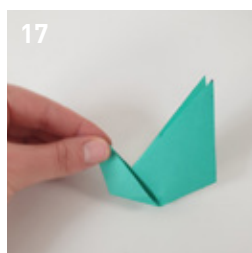

17 SQUEEZE TOGETHER TO MAKE FACE



18 POP OUT THE WINGS



19 POP OUT THE WINGS



YOU HAVE A SWAN!